

## Application



Vehicle Scale, Crane, Lifts  
适用于行车、吊机等

## Parameter

Material 材料: Alloy 合金钢, Stainless 不锈钢

Capacity 量程: Customer Design

Rated Output 额定输出: 1mV/V, 3mV/V

Non Linearity 非线性:  $\pm 0.1\%F.S.$

Hysteresis 滞后:  $\pm 0.01\%F.S.$

Repeatability 重复性:  $\pm 0.03\%F.S.$

Creep (30min) 蠕变:  $\pm 0.05\%F.S.$

Zero Balance 零点输出:  $\pm 1.00\%F.S.$

Tem.Effect on Zero 零点温度系数:  $\pm 0.1\%F.S./10^{\circ}C$

Tem.Effect on Output 额定输出温度系数:  $\pm 0.1\%F.S./10^{\circ}C$

Input Impedance 输入电阻:  $385 \pm 10\Omega$

Out Impedance 输出电阻:  $350 \pm 3\Omega$

Insulation Impedance 绝缘电阻:  $\geq 5000M\Omega$

Excitation Voltage 供桥电压: 10V (DC/AC)

Compensated Tem.Range 补偿温度范围:  $-10^{\circ}C \sim +50^{\circ}C$

Service Tem.Range 使用温度范围:  $-20^{\circ}C \sim +60^{\circ}C$

Safe Overload Range 安全过载:  $120\%F.S.$

Protection Class 防护等级: IP67, IP68

Cable length 电缆长度: 3m

Wire Code 接线方式: Red 红 (Ex+) Black 黑 (Ex-)

Green 绿 (Sig+) White 白 (Sig-)

## Outline Dimensions

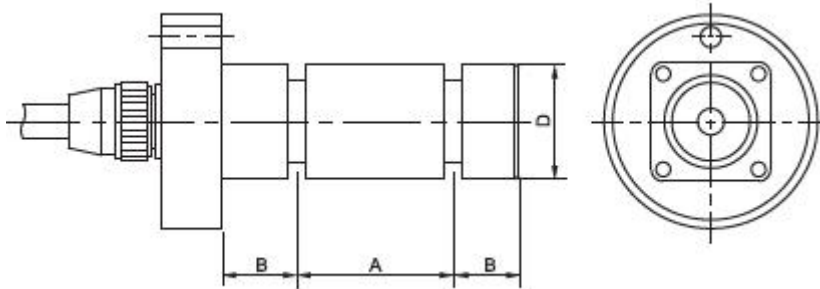

Dimension could be specially designed by capacity or other requirements.

